

# University House

## Woodhouse Rooms



### Room Layout Sizes



Theatre Style  
**120**



Classroom Style  
**N/A**



Exhibition  
**N/A**



Reception Style  
**200**



Dining Style  
**100**



Boardroom Style  
**N/A**



U-Shape Style  
**N/A**



Cabaret Style  
**36**

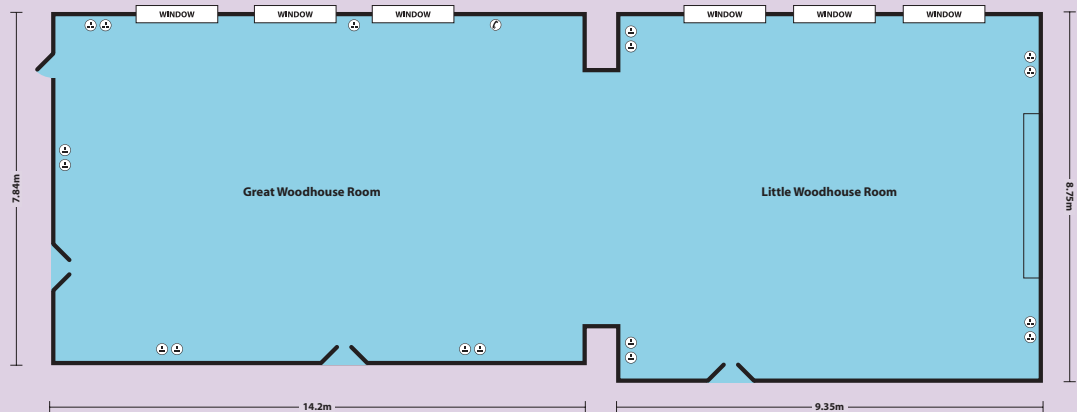

### Technical Information

- Ceiling Height – 4m
- Air Conditioning – No
- Blackout – Yes with curtains
- Natural Daylight – Yes
- Wheelchair Access – Yes
- Lighting – Standard with dimmer switches
- Room Size – 111.32m<sup>2</sup> (Great Woodhouse)  
81.81m<sup>2</sup> (Little Woodhouse)
- Controls in Room – Yes
- Internet Connection – Yes, wireless

### Audio-Visual Equipment

Room comes with OHP, screen & flipchart as standard. All other audio-visual equipment can be provided on request.

Please contact us for prices.

Universally Leeds, Conference & Events Office, University of Leeds,  
University House, Cromer Terrace, Leeds, LS2 9JT

Telephone : +44 (0)113 3436100 | Fax : +44 (0)113 3436107  
E-mail : enquiries@universallyleeds.co.uk | Web : www.universallyleeds.co.uk