

Exhibition Centre

Exhibition Halls 1 & 2



Room Layout Sizes



Theatre Style
N/A



Classroom Style
N/A



Exhibition
1155sqm (Hall 1)
596sqm (Hall 2)



Reception Style
N/A



Dining Style
N/A



Boardroom Style
N/A



U-Shape Style
N/A



Cabaret Style
N/A

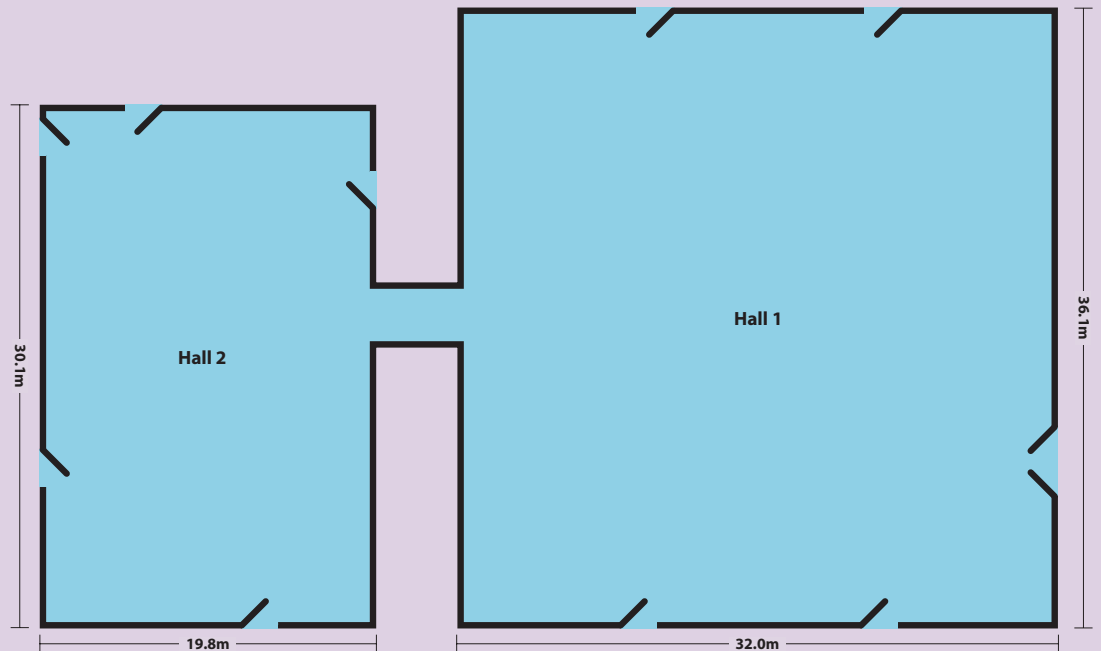

Technical Information

Ceiling Height	- 9m
Air Conditioning	- No
Blackout	- Yes
Natural Daylight	- No
Wheelchair Access	- Yes
Lighting	- Sodium Tungsten (Hall 1) - Florescent (Hall 2)
Room Size	- 1155m ² (Hall 1) - 595.98m ² (Hall 2)
Controls in Room	- Yes
Internet Connection	- Yes, wireless
Three Phase Power	- Yes

Audio-Visual Equipment

Audio-visual equipment can be provided on request.

Please contact us for prices.

Universally Leeds, Conference & Events Office, University of Leeds,
University House, Cromer Terrace, Leeds, LS2 9JT

Telephone : +44 (0)113 3436100 | Fax : +44 (0)113 3436107
E-mail : enquiries@universallyleeds.co.uk | Web : www.universallyleeds.co.uk